



**Applications
are now open
for the Post
Office Projects
2024 Exhibition
Program.**

**Applications
close at 11:59PM
on Monday 14th
August, 2023.**



Exhibitions

Post Office Projects is dedicated to furthering artistic practice and experimentation through the presentation of work by early to mid-career artists and curators. Supporting them to take the next big step in their career by providing spaces to experiment and test ideas.

There are two exhibition spaces – the Gallery and Vestibule, programmed through a combination of invitation and open call. Supporting critical engagement with each exhibition will be a public program of artists talks.



Exhibitions

POST OFFICE PROJECTS WILL PROVIDE

- Installation & curatorial support.
- Artist fees inline with NAVA recommended rates.
- Artworks will be covered by the Post Office Projects contents insurance up to the value of AUD \$15,000.
- Media release and publicity.
- Listing the exhibition on the POP website.
- Gallery sitters.
- Advice and support for grant writing.
- Digital invitation sent to the mailing list.
- Artists will have two weeks between exhibitions in order to install their work, this time includes the de-installation of the previous exhibition.
- Cover all opening night costs including a bar, volunteer staff, and liquor license. Openings are typically held on the first Sunday of the exhibition period.

ARTISTS/CURATORS WILL PROVIDE

- High quality artworks ready to be installed during the assigned installation period.
- Artists must hold their own public liability insurance. They are responsible for contacting the Director with a reasonable amount of time if artworks are potentially dangerous or high risk, flammables, consumables, sharp implements or objects that may endanger the audience.
- Must sign a contract with POP outlining all responsibilities, expectations and pay a \$100 refundable security deposit.
- Photos, biography and brief artist statement for promo six weeks prior to opening night.
- Artists will provide regular updates to the Director regarding the development of their work. These may take the form of a studio visit, phone call or email. They may include providing progress images.

CODE OF CONDUCT

Post Office Projects is a space that values respect, community, communication and experimentation. While we aim to create critical dialogue between our artists and audiences, we do so in a safe, accessible and welcoming space for all our communities and audiences. Any applications that contain artworks or behaviours that are threatening, demeaning or may isolate social, cultural, marginalised or racial groups will not be accepted. This includes sexism, homophobia, transphobia, classism and ableism. Any persons or exhibitions violating this code will be removed from the premises.

GALLERY HOURS

Wednesday – Saturday 12 – 5 pm or by appointment.

SALE OF WORKS

Post Office Projects will be responsible for all sales in the gallery. POP takes a 20% commission on works sold through the gallery.

AV EQUIPMENT

Post Office Projects has limited audio and visual equipment. Please contact the Director if you wish to access this equipment.

OFF-LINE

Kaurna Country
175 St Vincent St
Port Adelaide 5015
South Australia

ON-LINE

Web: www.postofficeprojects.com.au
Email: director@postofficeprojects.com.au
FB: Post Office Projects Gallery + Studios
IG: @pop_gallerystudios

Gallery

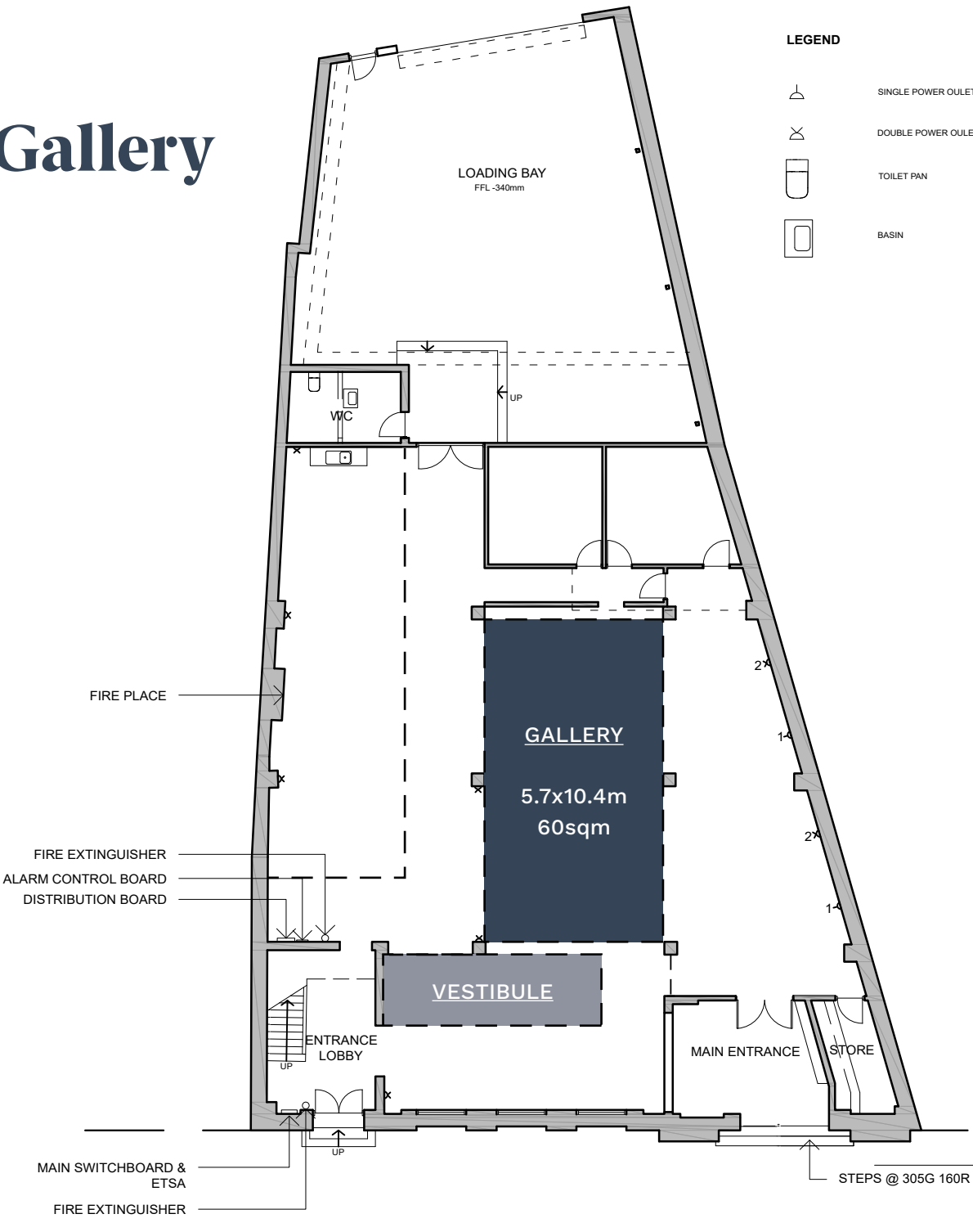

PLAN_EXISTING_1:200

ST VINCENT STREET

OFF-LINE

Kaurna Country
175 St Vincent St
Port Adelaide 5015
South Australia

ON-LINE

Web: www.postofficeprojects.com.au
Email: director@postofficeprojects.com.au
FB: Post Office Projects Gallery + Studios
IG: @pop_gallerystudios

Selection Criteria

**Quality of the past artwork
or works-in-progress**

**Demonstration of innovative,
challenging, experimental
and critically-engaged artistic
and curatorial practice**

**Potential for the exhibition to
further the careers of the artists,
curators and those involved.**

Process

There is no fee to exhibit at Post Office Projects. Exhibiting artists will present an artist talk open to the public and suggest a title for the Art x Fiction Library. The Director will work with exhibiting artists to provide curatorial feedback throughout the development of the exhibition, and to support grant applications.

Submission forms can be found here:
<https://www.postofficeprojects.com.au/eoi>

Applications close 11:59PM Monday
14th of August 2023.

Post Office Projects Gallery accepts exhibition proposals from early and mid-career artists and curators based locally, regionally, nationally and internationally throughout the year. Proposals will be assessed on an on-going basis and successful applicants will be contacted by the Director. All applications will be assessed against the selection criteria below, and if required, the Director will contact the applicant for more information.

If you have any questions, or would like to arrange a time to visit the gallery prior to submitting an application, please contact the Post Office Projects Director:

Eleanor Scicchitano
director@postofficeprojects.com.au
Subject: EOI POP Gallery

OFF-LINE

Kaurna Country
175 St Vincent St
Port Adelaide 5015
South Australia

ON-LINE

Web: www.postofficeprojects.com.au
Email: director@postofficeprojects.com.au
FB: Post Office Projects Gallery + Studios
IG: @pop_gallerystudios

EOI Form Details

Artist/s Details

- ➔ Applicant Name – please include your pronoun (artist name, curator, contact name for group exhibitions).
- ➔ List of all artist involved if applying for a group show – please include pronouns.
- ➔ Contact phone number.
- ➔ Residing City & State.
- ➔ Website – include all artist websites if you are applying for a group show.

Artistic Practice

- ➔ Artist Biography – Describe your professional practice to date (max. 300 words). If you are applying as a curator or group exhibition, please include the curator's biography, or the biography for the contact artist. Exhibiting artist biographies can be included as part of your support material.
- ➔ Artist Statement / Curatorial rationale: Proposed exhibition ideas, process, research. You do not need to know what the final project will look like. We are interested in your ideas, and the direction in which you are taking your practise or curatorial ideas. (max. 500 words)
- ➔ All preferred months of exhibiting with us?
- ➔ Preferred exhibition space?

Support Material

- ➔ Individual artists may include up to 10 images and 3 minutes of video with your application. *Include your full name in ALL file names.*
 - ➔ Image list - Please upload an image list including all image details (title, medium, size, year completed). Include your full name in the file name.
 - ➔ For curators and group exhibitions, you may include an additional 10 images, and total 10 minutes of video. *Include your full name in ALL file names.*
 - ➔ Artist biographies - For curators and group exhibitions, you may include an additional document with artist biographies for each of your participating artists (max. of 2 pages as a single pdf)
- ➔ *If you have any technical difficulties when uploading files, please email them to director@postofficeprojects.com.au with your full name and "EOI POP Gallery" in the email subject.*

Applicant Direction

- ➔ Information provided to the applicant.

Applicant Declaration

- ➔ The applicant is over 18 years of age.
- ➔ All information provided in this application is correct.
- ➔ All artworks submitted are original artworks created by the applicant or participating artists.
- ➔ If successful, the applicant will sign an Exhibition Agreement.
- ➔ The applicant holds public liability insurance with a minimum coverage of \$10 million or will secure the insurance prior to installing the exhibition.
- ➔ The applicant acknowledges that submitting an application is no guarantee of success.

OFF-LINE

Kaurna Country
175 St Vincent St
Port Adelaide 5015
South Australia

ON-LINE

Web: www.postofficeprojects.com.au
Email: director@postofficeprojects.com.au
FB: Post Office Projects Gallery + Studios
IG: @pop_gallerystudios

Post Office Projects acknowledges the Kaurna people of the Adelaide Plains as the traditional owners of the land upon which the gallery resides. It is also The Place of the Kardi, the Emu, whose story travels from the coast inland.

We pay respect to Elders past and present. We recognise and respect their cultural heritage, beliefs and relationship with the land. We acknowledge that they are of continuing importance to the Kaurna people living today.

